

# J.BURROWS

• • • • •

## ASSEMBLY INSTRUCTIONS

---

### ASHTON 2 DRAWER LATERAL FILING CABINET

### JBASH2DCAB

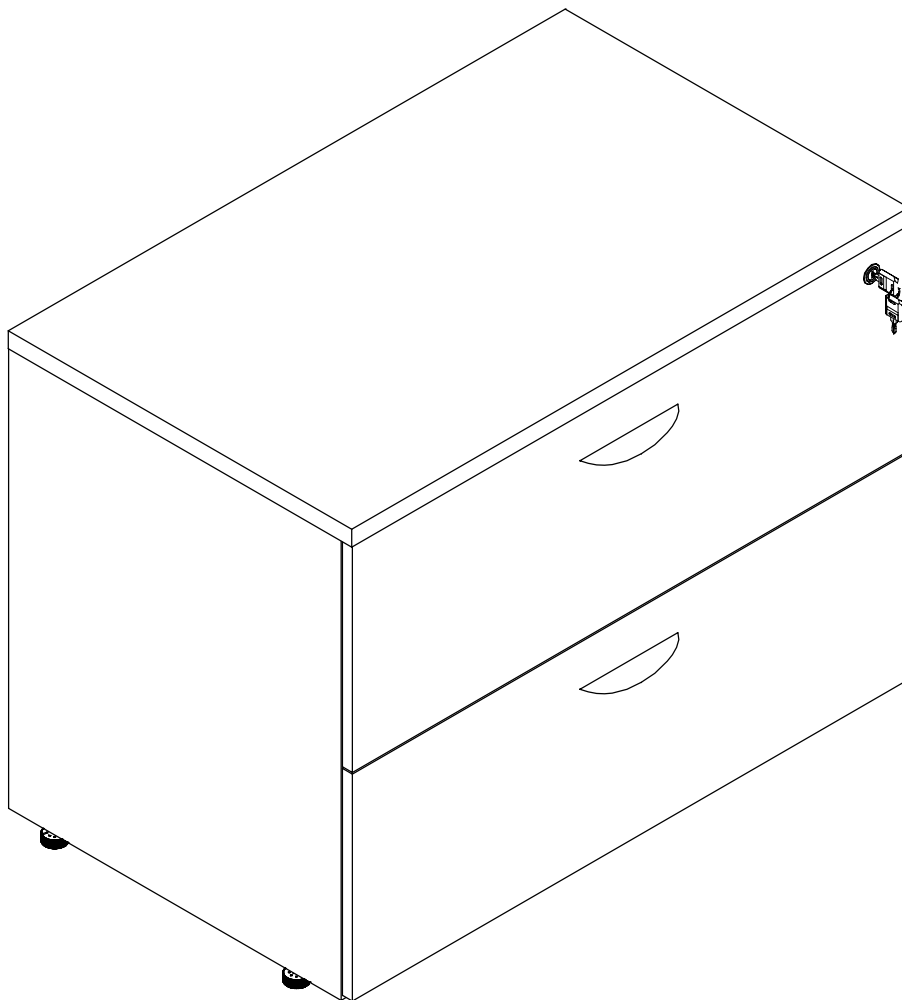

This design and instruction booklet is subject to copyright.  
[www.officeworks.com.au](http://www.officeworks.com.au)

1CTN

## Tools Required For Assembly

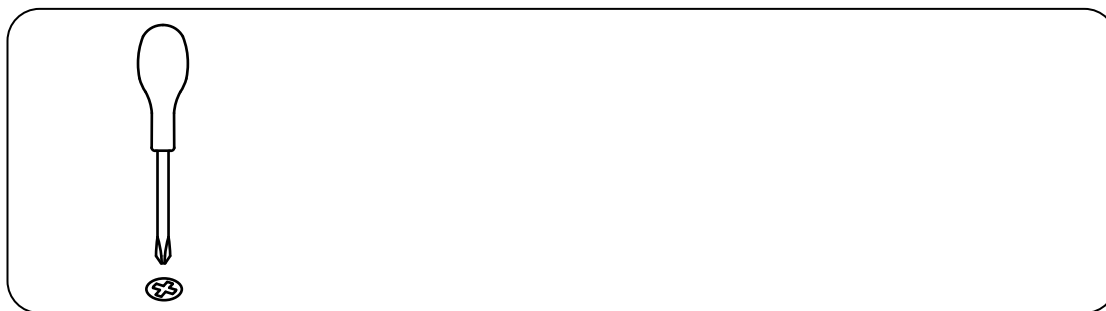

Recommend 2 Adults to Assemble

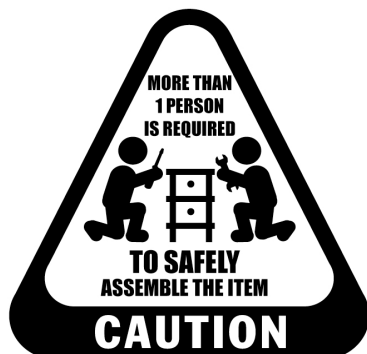

Assemble Item On a Clean Flat Surface

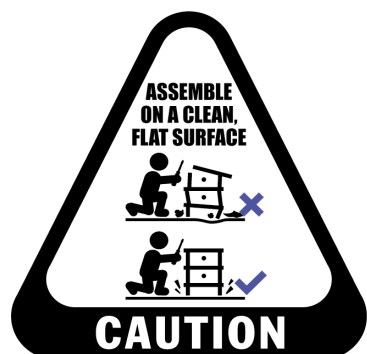

## WARNING

- Please check you have all hardware before assembling.
- If you think you are missing any hardware please contact the store of purchase.
- Please ensure you have the name of the item and hardware part required and quantity.
- Please retain your receipt for proof of purchase to validate warranty. Enjoy your new purchase.
- Do not tighten the screws before all screws are in right place.
- Do not use this cabinet unless all bolts, screws and knobs are firmly secured.
- At least every 4 months, check all bolts, screws and knobs to be sure they are tight.
- If parts are missing, broken, damaged or worn, stop use of the product until repairs are made, using factory authorized parts.
- Failure to follow these warnings could result in serious injury.

## PARTS LIST

①

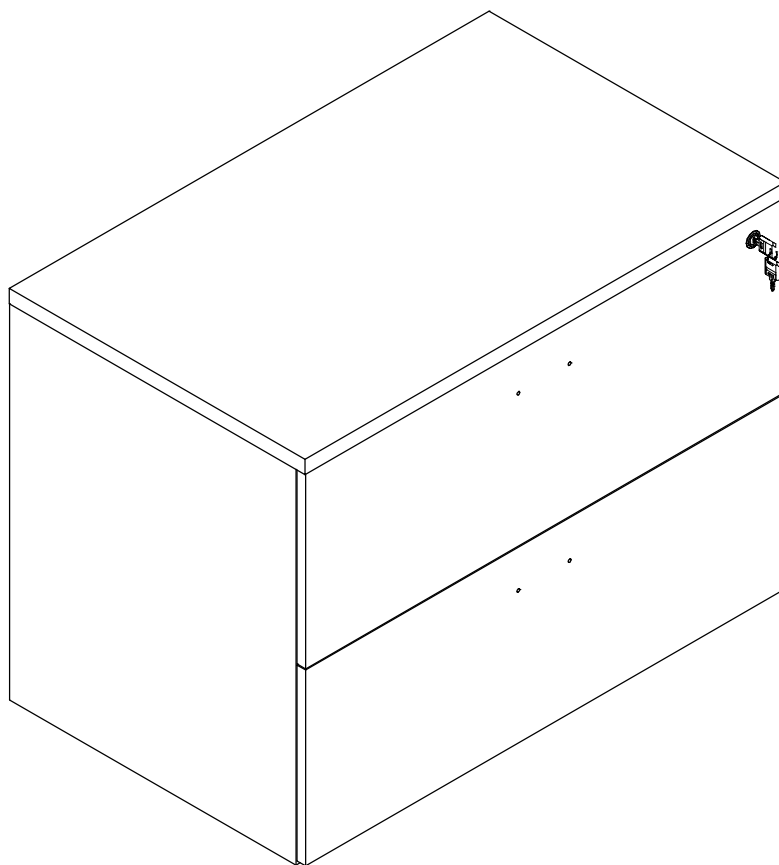

x1Pc

## HARDWARE LIST

A

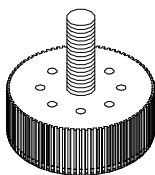

x4Pcs

B

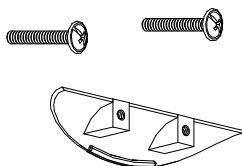

x2Pcs

C

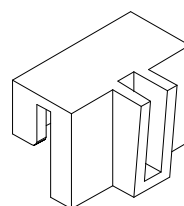

x8Pcs

D

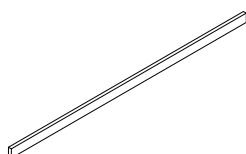

376mm  
x4Pcs

## Step 1

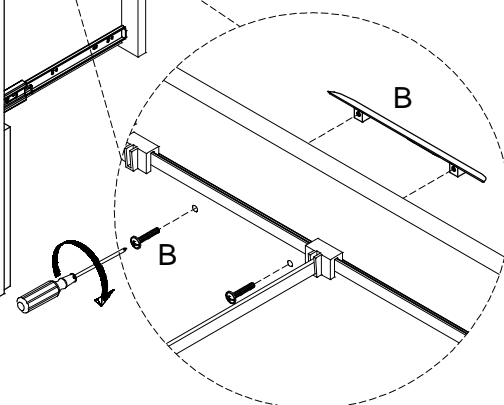
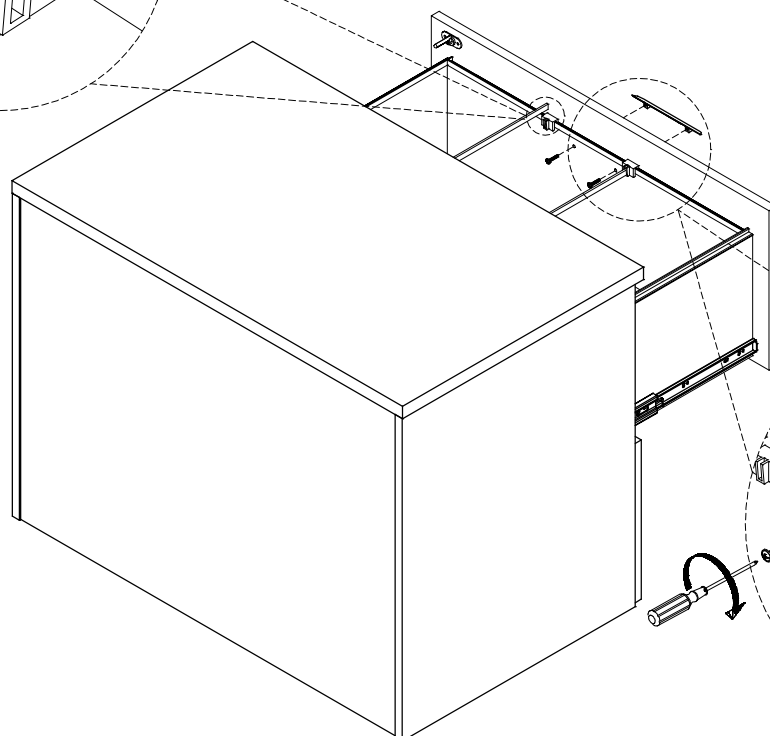
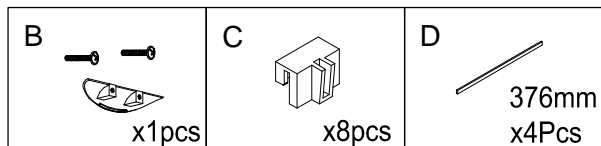
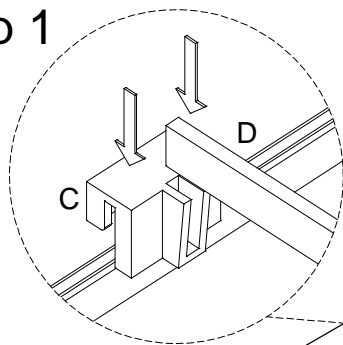

## Step 2

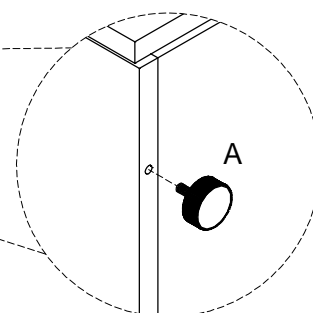
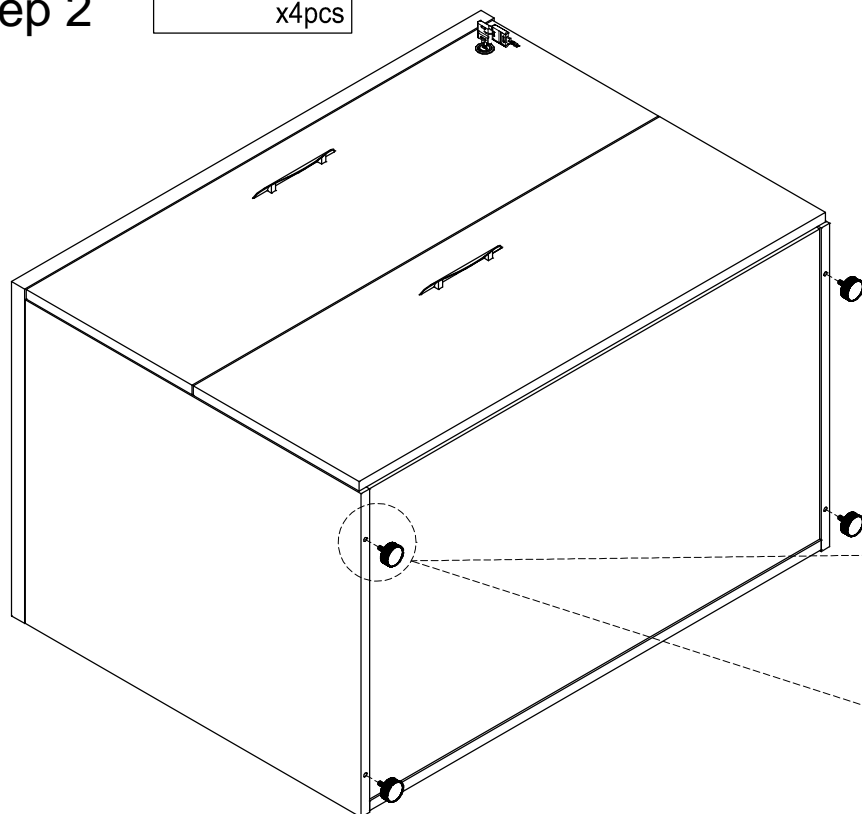
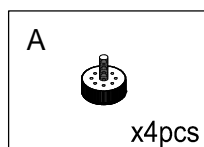

## Step 3

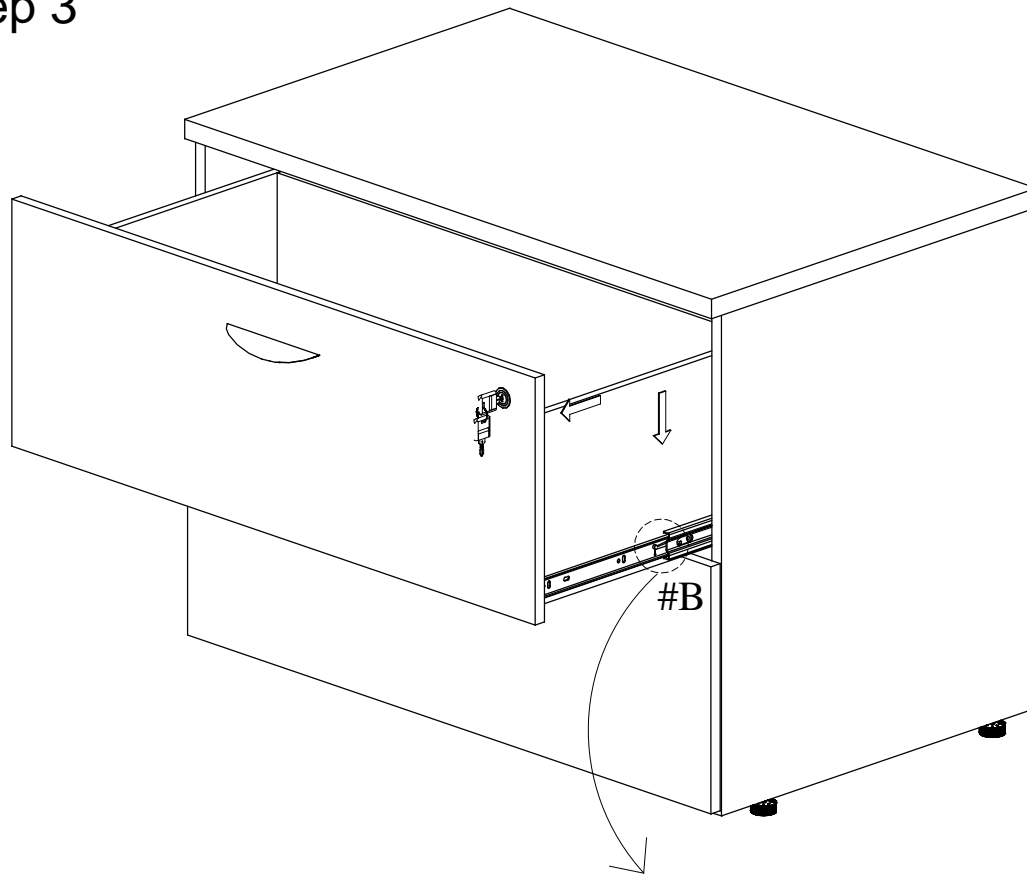

**If you need to remove the drawer, please pull the drawer all the way out, then simultaneously push the plastic release lever of the ball bearing slides up on one side and down on the other side, and then pull the drawer completely out. As shown.**

left

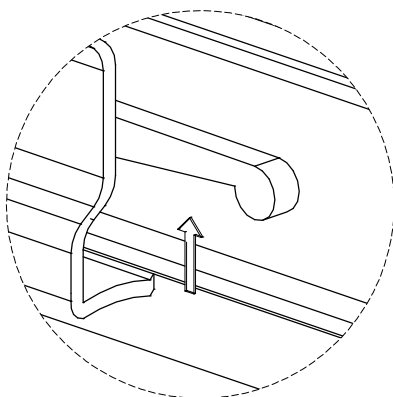

Detail #B

right

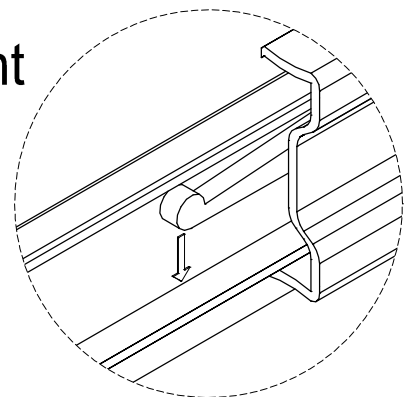

Detail #B

## Step 4

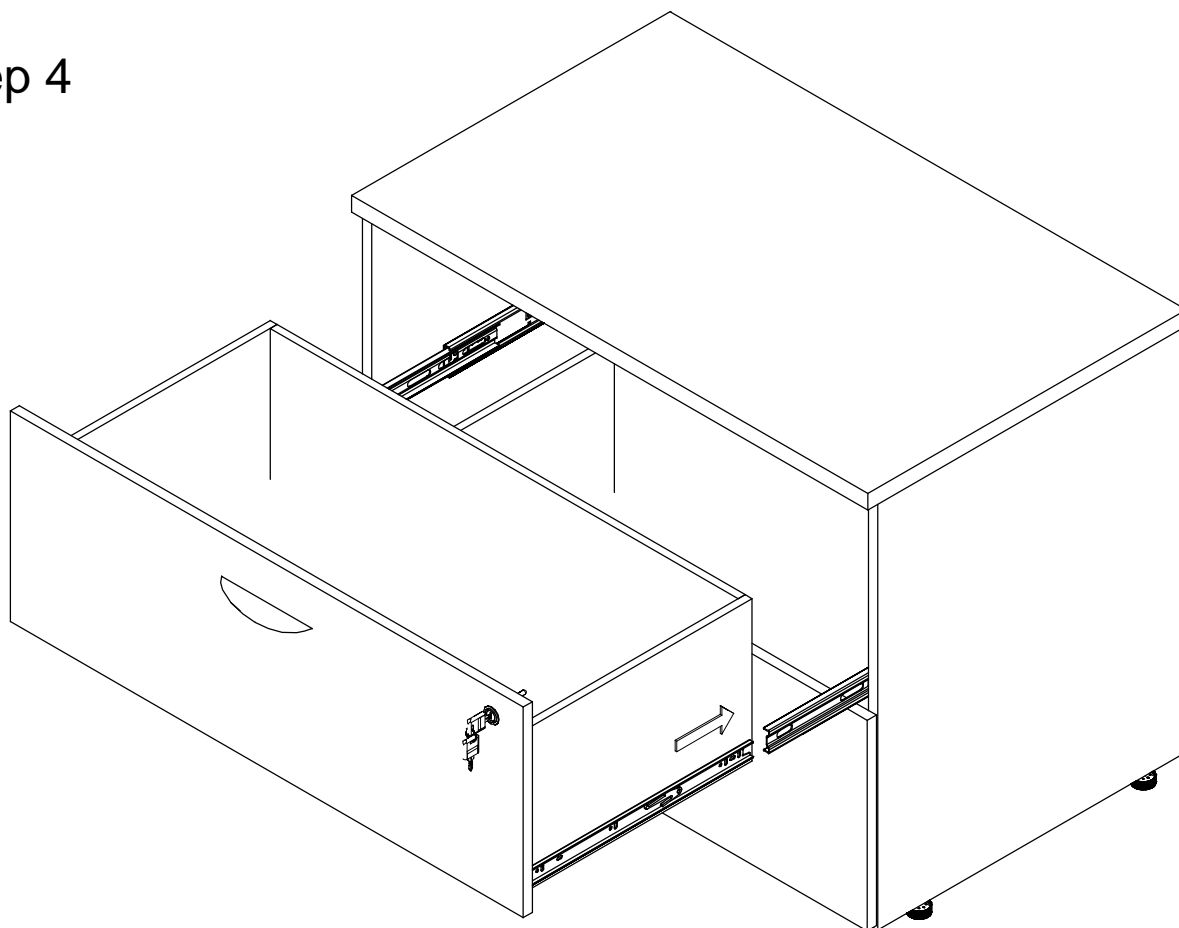

**To place the drawer back, simply push the ball bearing cart all the way to the end of the slides (in both sides), and align the slide runners on the drawer with the slide tracks on the unit. Push it carefully inside until it stops. If the drawer does not go in smoothly, please take it out and repeat the step.**

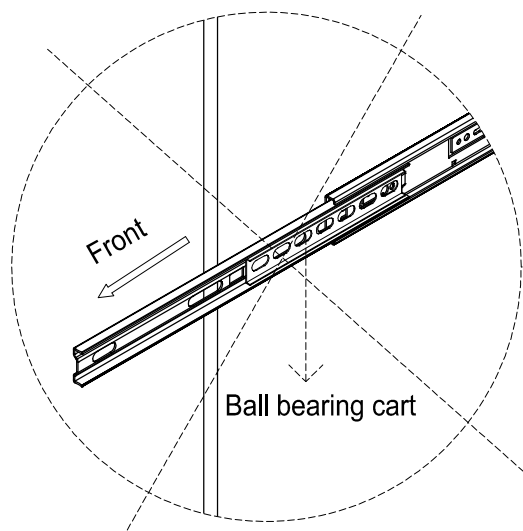
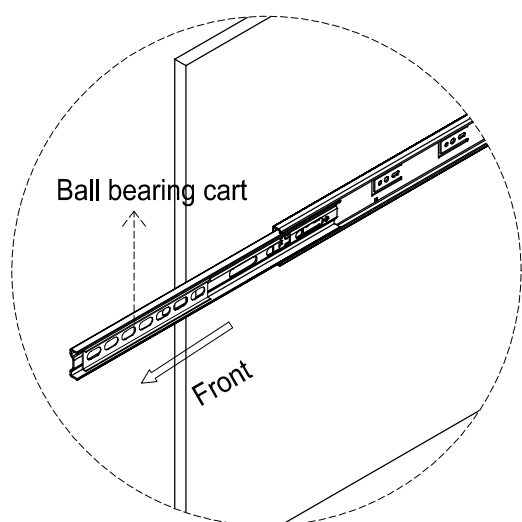

## Step 5

# MAXIMUM WEIGHT CAPACITY

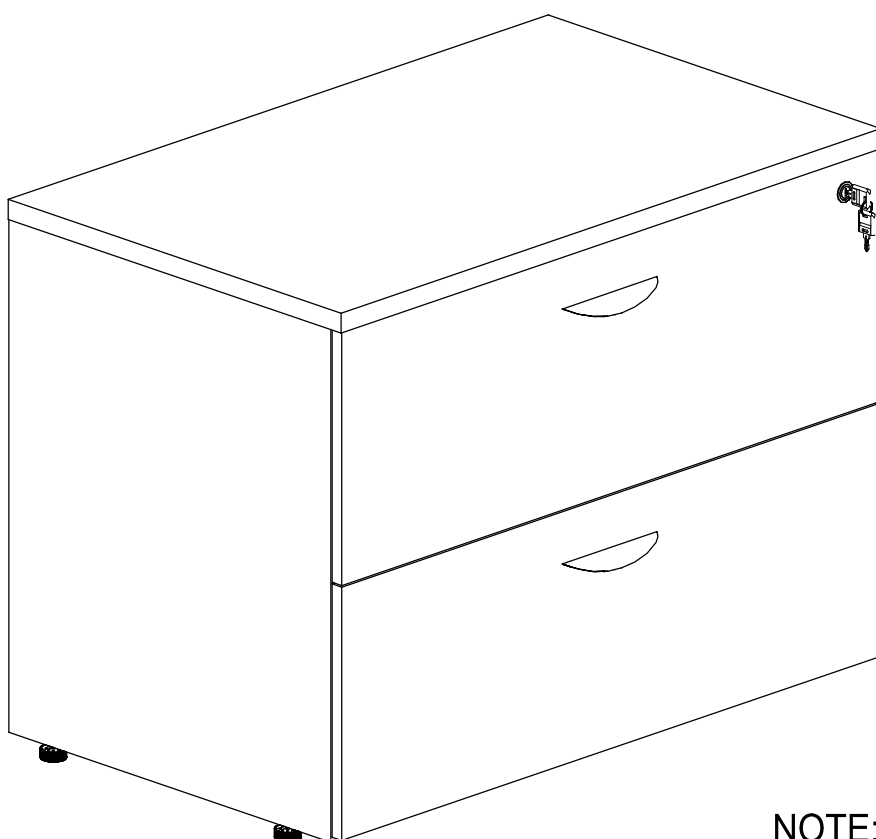

NOTE: each drawer weight capacity is 30 kg



CAUTION: This product is intended to hold the maximum weight indicated. Exceeding the maximum weight will result in instability and may cause injury.

**Thank you for purchasing our product!** Please retain your receipt to validate warranty. If you'd like to know more about Officeworks' furniture products, please visit our website. [www.officeworks.com.au](http://www.officeworks.com.au)